

LOW PROFILE VERTICAL HI-RISE FAN COIL UNITS (SHORT CABINET) TYPE M CONCEALED MASTER MODEL SERIES: 39L

MODELS:

- 39LZ** Chilled Water.
- 39LZW** Chilled and Hot Water.
- 39LZE** Chilled Water and Electric Heat.

2 Pipe System:

- 3 Row coil.
- 4 Row coil.

4 Pipe System:

- 4 Row - 3 CW, 1 HW coil.
- 5 Row - 3 CW, 2 HW coil.
- 5 Row - 4 CW, 1 HW coil.

STANDARD FEATURES INCLUDE:

- 20 ga. (1.0) galvanized steel casing.
- Three speed (tap) PSC motor with thermal overload protection.
- 1/2" (13) x 2 lb/cu.ft. density water repellent insulation.
- 1" (25) throwaway filter.
- Galvanized steel insulated drain pan.
- Factory installed P-Trap.
- Supply grille(s).
- Front return panel (see separate submittal) with powder coat finish.
- Factory installed piping package(s).

OPTIONS:

- Ultra-high efficiency Epic ECM motor.
- Ultra-high efficiency 3-Speed ECM.
- Electric Heat.
- 18 ga. (1.3) galvanized steel casing.
- Stainless steel drain pan.
- Outside air damper.
- Steri-liner insulation.
- Fiber-free insulation.
- 1" (25) MERV 8 filter.
- Top supply outlet.
- Special features: _____

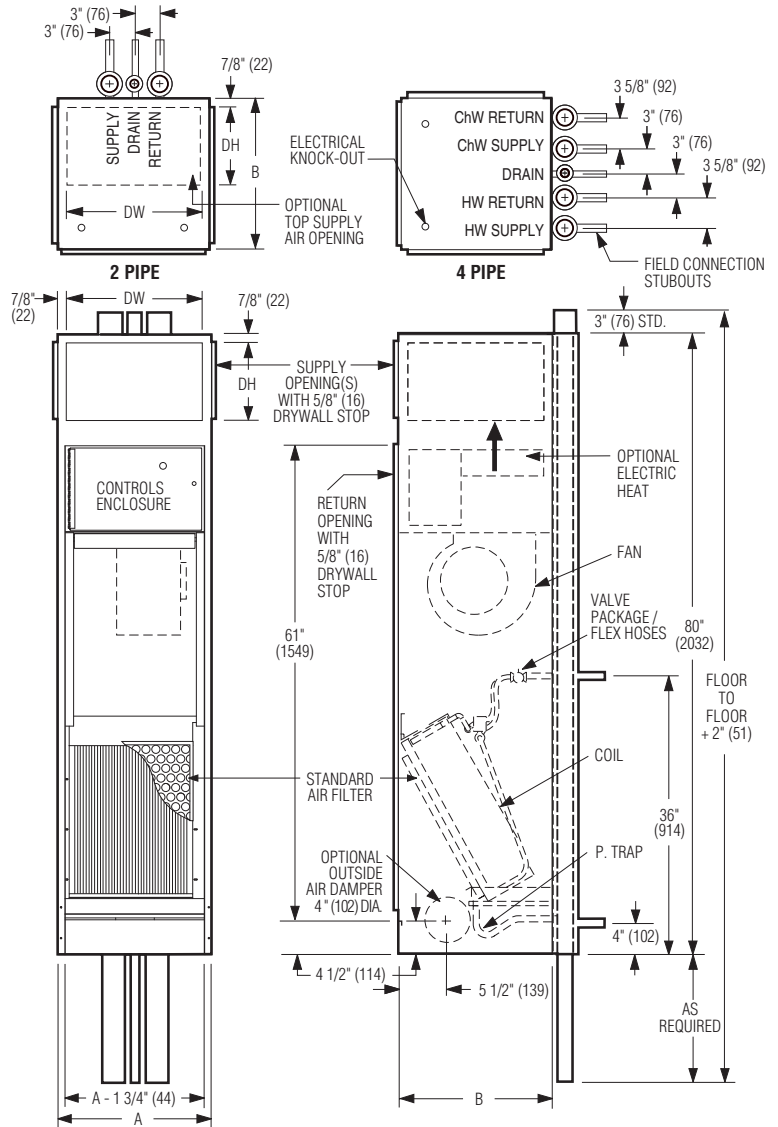

Dimensional Data.

Unit Size		Footprint A x B	Supply Grille Nominal DW x DH	Standard Filter Size
PSC Motor	ECM Motor			
3, 5, 6	6	18 x 18 (457 x 457)	16 x 10 (406 x 254)	13 1/8 x 16 3/4 (333 x 425)
8, 10	10	20 x 20 (508 x 508)	18 x 10 (457 x 254)	15 1/2 x 24 (394 x 610)
12, 15	15	24 x 24 (610 x 610)	22 x 10 (559 x 254)	18 1/2 x 29 (470 x 737)
19, 21	19	30 x 24 (762 x 610)	28 x 10 (711 x 254)	24 1/2 x 29 (622 x 737)

NOTES:

1. Wiring from electrical entry knock-out to controls enclosure is furnished and field installed by others.
2. Risers available from 3/4" (19) to 3" (76) dia. with either 1/2" (13) or 3/4" (19) thick insulation.
3. Max. riser length is 112" (2845), 92" (2337) min.
4. Back riser location shown. See separate submittal for available riser and discharge grille unit configurations.
5. All piping and insulation between master and slave unit is furnished and field installed by others.
6. Riser stubouts are approx. 4 1/2" (114) long. Water connections are 5/8" (16) O.D. and drain connection is 7/8" (22) O.D.
7. Factory mounted risers shown. See drawing no. 39VH/L-2 for shipped loose riser details.

SCHEDULE TYPE:

PROJECT:

ENGINEER:

CONTRACTOR:

Dimensions are in inches (mm).

DATE	B SERIES	SUPERSEDES	DRAWING NO.
11 - 15 - 11	39	3 - 3 - 08	39L-2

